

Expressions Arts and Entertainment Centre

Upper Hutt's vision for a multi-purpose arts and recreation facility will soon be a reality. Designed by Architecture +, the new building will add an art gallery and 200-seat theatre, along with a café and hospitality areas to the existing civic hall.

**Opening
September
2003!**



"Our vision is for an inspired community celebrating expression."

Community focused operation

Upper Hutt City Council has contracted and part-funded the Expressions Arts and Entertainment Trust to operate the facility. The Trust is responsible for all promotion, programming and operation of Expressions.

Trustees are appointed by the Council. Expressions Trustees are Nicola Meek (Chair); Norma, Lady Beattie; Philip Bentley; Barry Houston; Bryan Jackson; Tom Leckie; and Peter Richardson. In addition the Trust has appointed an Advisory Trustee from Orongomai Marae, Joy Bullen.

Stephanie Cottrill has been appointed Director of Expressions, to oversee operation of the Centre, and to actively promote new and exciting arts opportunities in the city.

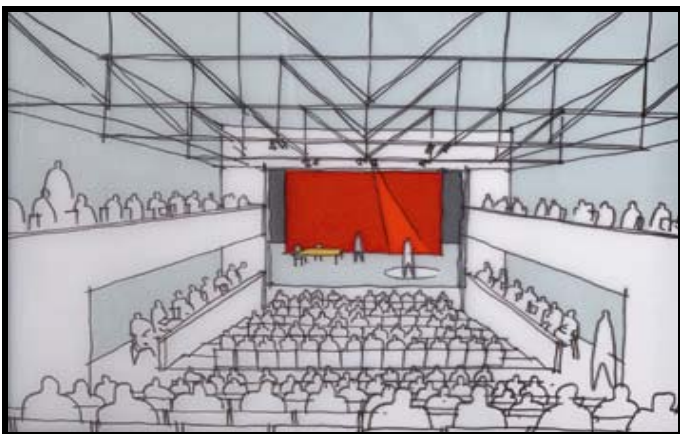

Multi-use design

The multi-use design of Expressions will allow a range of activities to be offered, boosting leisure and entertainment opportunities in the city - from workshops, conferences, exhibitions, and sporting activities, through to performances, special events and community celebrations. The new facility will also continue to allow for craft shows and other large events which may take up the whole building.

Expressions may also hold workshops in schools or other community locations, and help support other activities that are great for the city. The facility will assist growth in our creative community, both in people taking part, and in the quality standards of our arts community. From consumers to performers, there will be opportunities at Expressions for everyone.

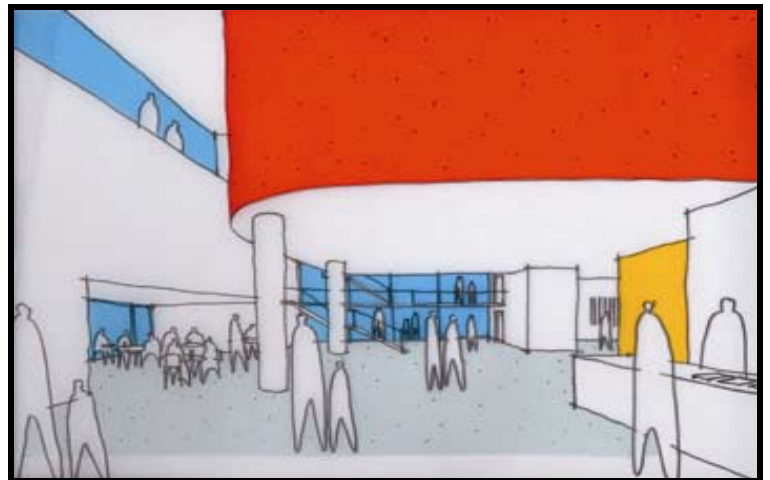

"Expressions is all about bringing the community together, to show what we can do, and how well we can create, perform and celebrate together."

Working together

The Trust is continuing to work with existing arts groups, including the Friends of Expressions, which is fundraising \$1,000,000 towards the fitout and future programming of Expressions. The Friends will also foster interest and continued support for the new facility and back the Trust's initiatives to bring the finest art, theatre, ballet, music, kapa haka and shows to Upper Hutt.

OWNED by Upper Hutt City Council
OPERATED by Expressions Arts and Entertainment Trust
SUPPORTED by Friends of Expressions
FUNDED by the Upper Hutt community
ENJOYED by everyone!

Features - Expressions Arts and Entertainment Centre

The ground floor includes display spaces, the foyer and existing Civic Hall. Features include:

Gallery and display spaces

- two gallery areas - 4 metre height with 80 linear metres of display space
- multi-purpose display capability
- fully environmentally controlled

Existing hall

- 40 by 20 metre sport and recreation hall
- wooden sprung floor

Foyer

- glass front facing Fergusson Drive
- will function as a multi-purpose exhibiting and activity space.
- catering facilities/café/bar

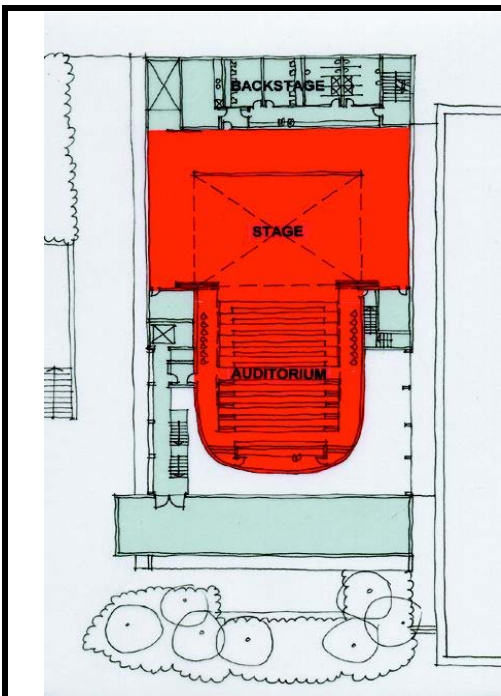
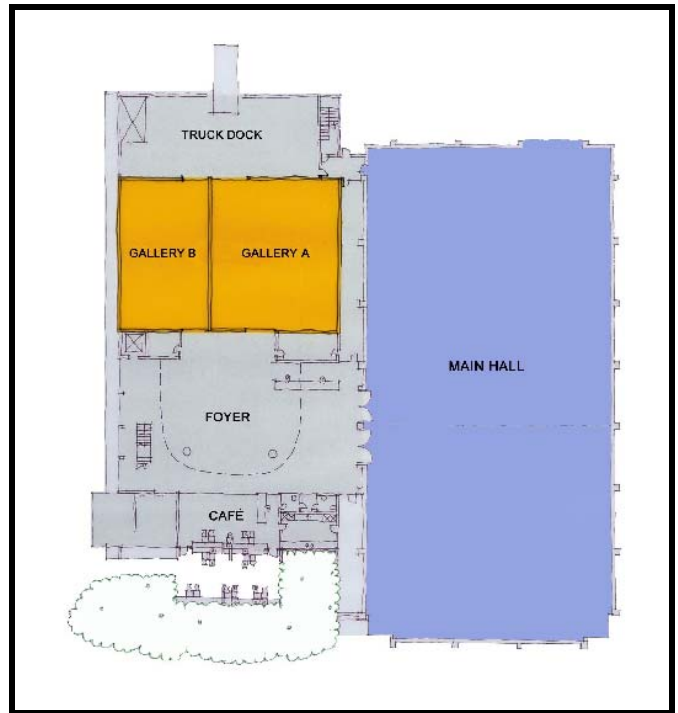

The upper level includes the theatre, offices and green rooms. Features include:

Theatre

- seating for 200 – each of these seats is for sale! Seating is tiered and includes gallery seating along the sides. The front area has flexibility to enable use as a theatre restaurant. Specific accessibility seating is provided. (Refer to the artist impression overleaf.)
- public elevator
- full-size stage and wings
- air conditioning
- lighting and sound equipment
- backstage changing rooms and green room
- scenery hoist

Above right: a floor plan of the ground floor.

Above left: a floor plan of the upper level.

At right: a cross section of Expressions from the Civic Hall side.

Overleaf

Above left: view from Fergusson Drive locating Expressions between the Council building and H²O Xstream.

Centre right: artist impression of the foyer.

Bottom left: artist impression of the upper-level auditorium.

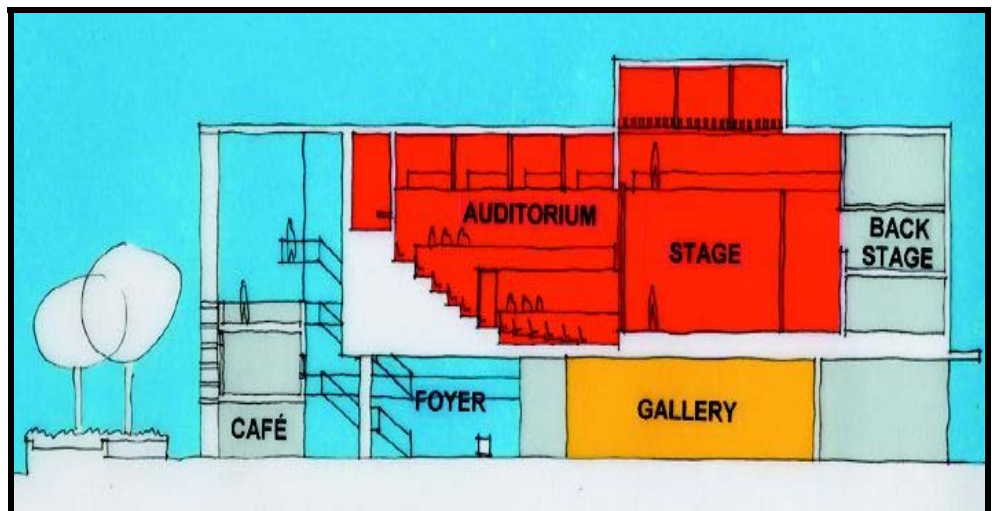

For bookings and information contact:
Expressions Arts and Entertainment Centre
836 Fergusson Drive
PO Box 40 594
Upper Hutt

p (04) 527 2168
f (04) 527 2180
e info@expressions.org.nz
www.expressions.org.nz